

PRE INSTALLATION CHECKLIST

IMPORTANT NOTICE: If you have purchased a STI-6400/WIR model, before installation you will need to 'learn' the transmitter to the 8 channel receiver. Please refer to the Quick Setup Guide. Once 'learned', follow steps 1-7 opposite.

DO YOU WANT HIGH OR LOW SOUNDER OUTPUT?

The Exit Stopper is factory set for HIGH sounder output (105 dB). To change the unit to a LOW output (95 dB), locate JP2 and move to the OFF position.

DO YOU WANT THE EXIT STOPPER TO ALARM IMMEDIATELY?

The Exit Stopper is factory set to arm immediately after the key is turned to the ON position. You can change this to a 15 second arming delay. This feature allows an authorised key holder to turn the unit on and then exit through the door before the unit arms. To set a 15 second arming delay move jumper JP7 to the OFF position.

DO YOU WANT THE EXIT STOPPER TO ACTIVATE IMMEDIATELY THE DOOR IS OPENED?

The Exit Stopper is factory set to activate immediately the protected door is opened. The unit can be set for a 15 second delay. This would allow an authorised key holder to open the door and turn the Exit Stopper off before it activates. To set to a 15 second activation delay move the jumper to JP5 to the ON position.

SOUNDER OUTPUT OPTIONS

The Exit Stopper is factory set to sound for 30 seconds once activated. There are three other settings, 180 seconds, continuous and 5 beeps.

SPECIFICATIONS

Housing	3mm 1/8" polycarbonate
Power Source	9 VDC Alkaline
Sounder Output	95 dB - low/105 dB - high
Relay Output	9 VDC, 40mA
Dimensions	136mm/5.35" h x 136mm/5.35" w x 50mm/1.97" d
Standby Current	10uA
Alarm Current	200mA

EXIT STOPPER PART NUMBERS

PART No.	DESCRIPTION
STI-6400	Exit Stopper
STI-6402	Exit Stopper Double Door
STI-6400/RK	Remote Kit
STI-6400/RS	Remote Sounder

ACCESSORIES

PART No.	DESCRIPTION
STI F021	Tamperproof Tool
STI CO23/A	Spare Keys
STI BAT1	9 V Battery
STI L6400	Emergency Exit Warning Sign



Safety Technology International
Taylor House, 34 Sherwood Road, Bromsgrove
Worcestershire, B60 3DR, England
Telephone: +44 (0) 1527 520 999
Fax: +44 (0) 1527 501 999
E mail: info@sti-europe.com Web Site: www.sti-europe.com



ID6400-6400WIR · Revised 10/16-001 · Printed in England

EXIT STOPPER

A completely self-contained security system that provides a highly effective, extremely versatile and inexpensive way to help prevent unauthorised use of fire/emergency doors. The EXIT STOPPER is supplied with an installation kit and 9v alkaline battery. It also incorporates a key override facility for authorised use.

INSTALLATION DATA FOR THE STI-6400 & STI-6400/WIR

1. Make sure key switch is in the OFF position.

2. Remove cover from base unit by applying pressure to the key barrel. Ensure that the tamper screw located on the bottom right hand side is removed by using the tamperproof tool provided.

3. Set switches, on circuit board, to desired alarm settings (figure 4 see over).

4. Mount base unit on or next to door using the 2 fixings provided. (See Dia. A for recommendation*). Reed switch mounting locations can be moved to the four positions shown in Dia. A. If mounted next to door, route reed switch wire through knockout in bottom of housing as shown in figure 2.

5. Mount magnet on door frame (or door if unit is mounted next to door) using screws provided. When mounting on metal doors or door frames, use plastic spacer provided. Reed switch and magnet must be within 13mm/1/2" when door is closed. Please refer to figures 5, 6 and 7 for other mounting options.

6. To fix the cover to the base unit, hooks can be found on the inside top edge of the cover. Insert the hooks into the slots provided on the edge of the base unit (see Dia. B) and snap the cover down until it clicks into place. Using the tamperproof tool provided insert and tighten the screw to secure the cover to the base (see Dia. C).

7. REMOVING THE COVER FROM THE BASE
Remove the tamper screw located on the bottom right hand side with the tamperproof tool provided. Apply pressure to the key barrel. Keep the tamperproof tool safe for future servicing and battery change.

FIGURE 1

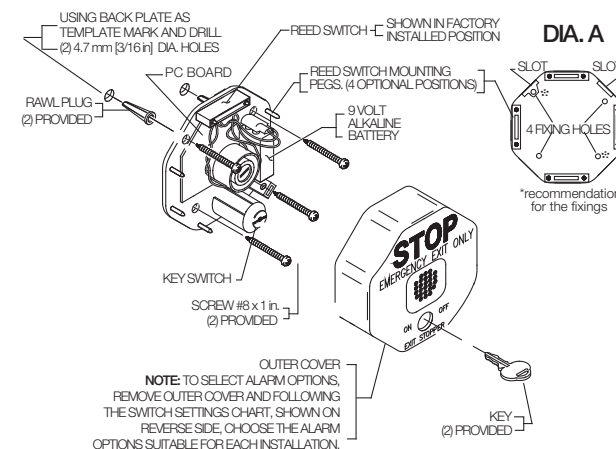
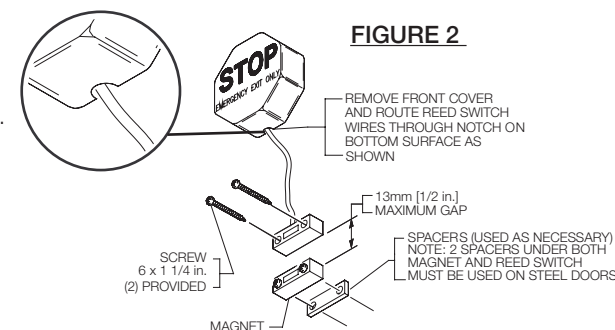
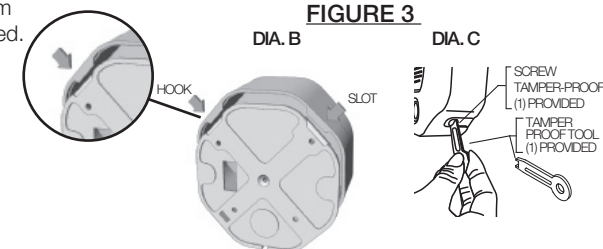

FIGURE 2



VIEW SHOWING MAGNET INSTALLATION
NB: FITTING UNIT AWAY FROM DOOR (OPTIONAL)

FIGURE 3



VIEW SHOWING HOW TO FIX THE COVER TO THE BASE

Need help? Call our Technical Support Team on +44 (0)1527 520 999

Need help? Call our Technical Support Team on +44 (0)1527 520 999

CIRCUIT BOARD SET-UP

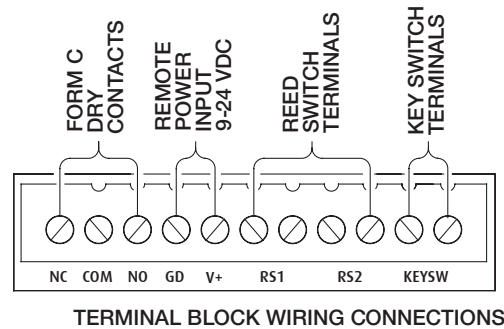
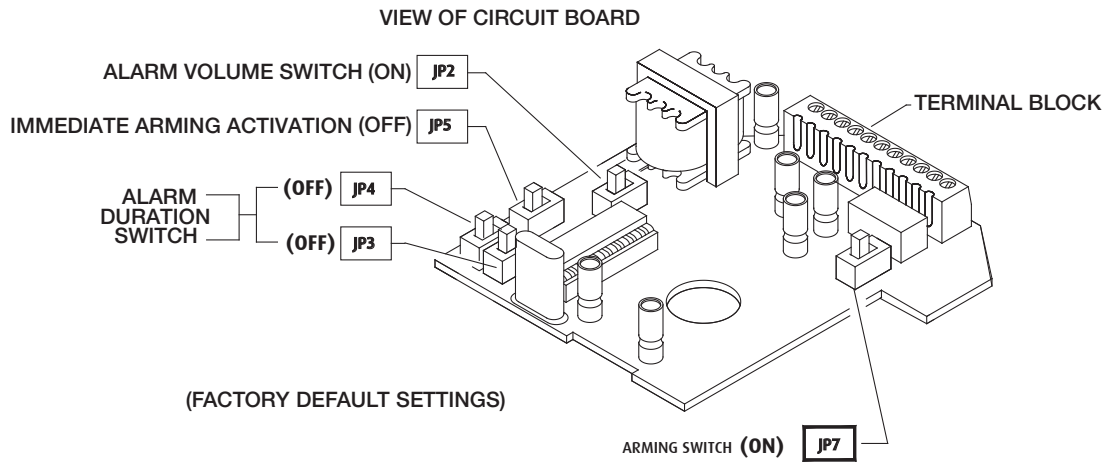

FIGURE 4

FEATURE	JP2	JP3	JP4	JP5	JP7
High Volume* (105 dB)	ON*				
Low Volume (95 dB)	OFF				
Immediate Arming*					ON*
15 Second Arming Delay					OFF
Immediate Arming Activation*				OFF*	
15 Second Activation Delay				ON	
30 Second Alarm Duration*		OFF*	OFF*		
180 Second Alarm Duration		OFF	ON		
Continuous Alarm Duration		ON	OFF		
Door Prop Mode (5 Beeps)		ON	ON		

***Factory Settings**

NOTE: Slide black lever to desired ON/OFF position as labelled on circuit board

MOUNTING OPTIONS

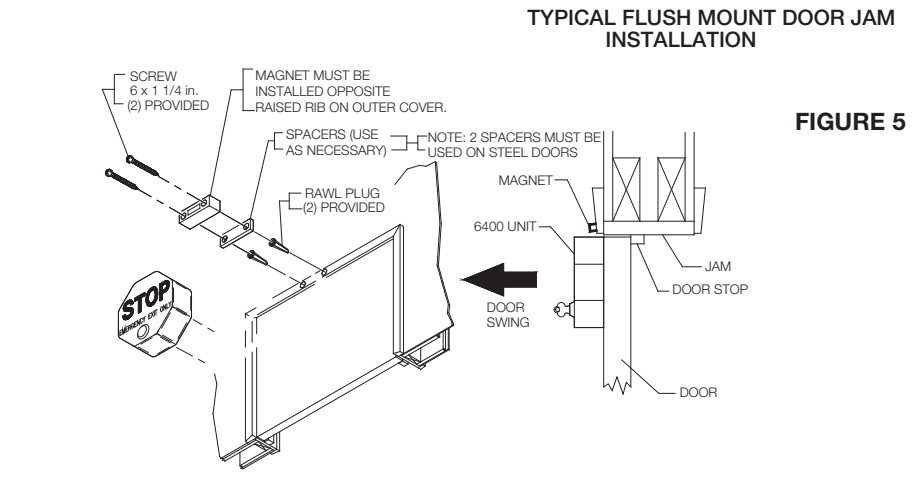

FIGURE 5

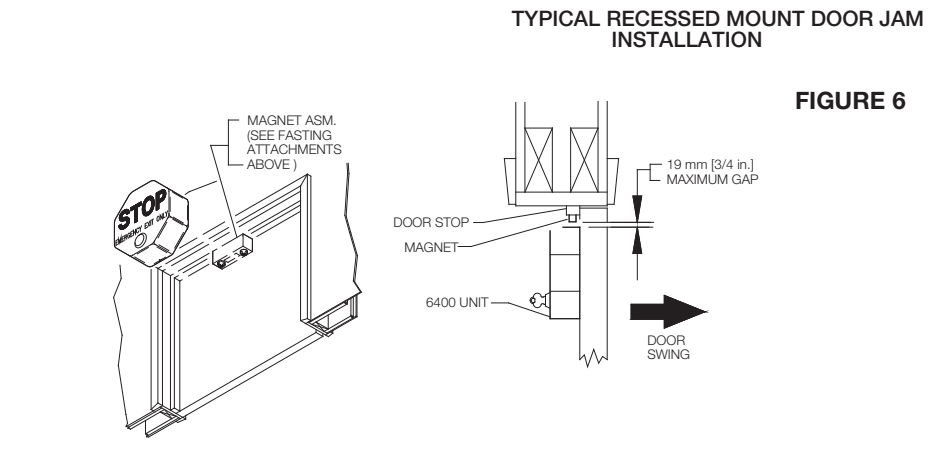

FIGURE 6

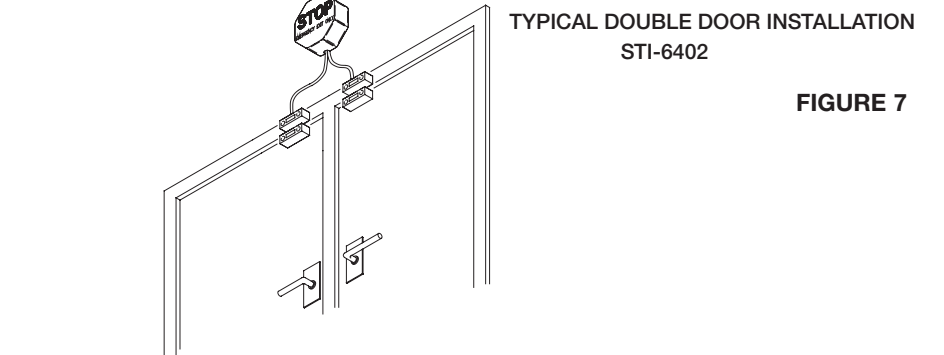

FIGURE 7